

SMA Female Connector Field Replaceable
Attachment 2 Hole Flange 0.020 inch Pin



TECHNICAL DATA SHEET

PE44026

SMA Female Connector Field Replaceable Attachment 2 Hole Flange 0.020 inch Pin

Configuration

Connector	SMA Female
Connector Specification	MIL-STD-348
Connector Interface Type	0.020 inch Pin
Cable Attachment Method (Shield/Contact)	Field Replaceable
Body Style	Straight
Mount Method	2 Hole Flange

Electrical Specifications

Frequency Range, GHz	DC to 18
Impedance, Ohms	50
Maximum VSWR	1.25:1

Mechanical Specifications

Size

Length, in [mm]	0.375 [9.53]
Width/Dia., in [mm]	0.22 [5.59]
Height, in [mm]	0.625 [15.88]
Weight, lbs [g]	0.006 [2.72]

Connector

Type	SMA Female
Contact Material and Plating	Beryllium Copper, Gold
Contact Plating Specification	MIL-G-45204, Type II, Class 2
Body Material and Plating	Passivated Stainless Steel
Body Plating Specification	QQ-P-35
Dielectric Type	Teflon

Compliance Certifications (visit www.Pasternack.com for current document)

RoHS Compliant	Yes
----------------	-----

Click the following link (or enter part number in "SEARCH" on website) to obtain additional part information including price, inventory and certifications: [SMA Female Connector Field Replaceable Attachment 2 Hole Flange 0.020 inch Pin PE44026](#)

The information contained in this document is accurate to the best of our knowledge and representative of the part described herein. It may be necessary to make modifications to the part and/or the documentation of the part, in order to implement improvements. Pasternack reserves the right to make such changes as required. Unless otherwise stated, all specifications are nominal.

SMA Female Connector Field Replaceable
Attachment 2 Hole Flange 0.020 inch Pin



TECHNICAL DATA SHEET

PE44026

Plotted and Other Data

Notes:

Values at 25 °C, sea level

SMA Female Connector Field Replaceable Attachment 2 Hole Flange 0.020 inch Pin from Pasternack Enterprises has same day shipment for domestic and International orders. Our RF, microwave and fiber optic products maintain a 99% availability and are part of the broadest selection in the industry.

Click the following link (or enter part number in "SEARCH" on website) to obtain additional part information including price, inventory and certifications: [SMA Female Connector Field Replaceable Attachment 2 Hole Flange 0.020 inch Pin PE44026](http://www.pasternack.com/sma-female-standard-0.020-pin-connector-pe44026-p.aspx)

URL: <http://www.pasternack.com/sma-female-standard-0.020-pin-connector-pe44026-p.aspx>

The information contained in this document is accurate to the best of our knowledge and representative of the part described herein. It may be necessary to make modifications to the part and/or the documentation of the part, in order to implement improvements. Pasternack reserves the right to make such changes as required. Unless otherwise stated, all specifications are nominal.

PE44026 CAD Drawing

SMA Female Connector Field Replaceable Attachment 2 Hole Flange 0.020 inch Pin

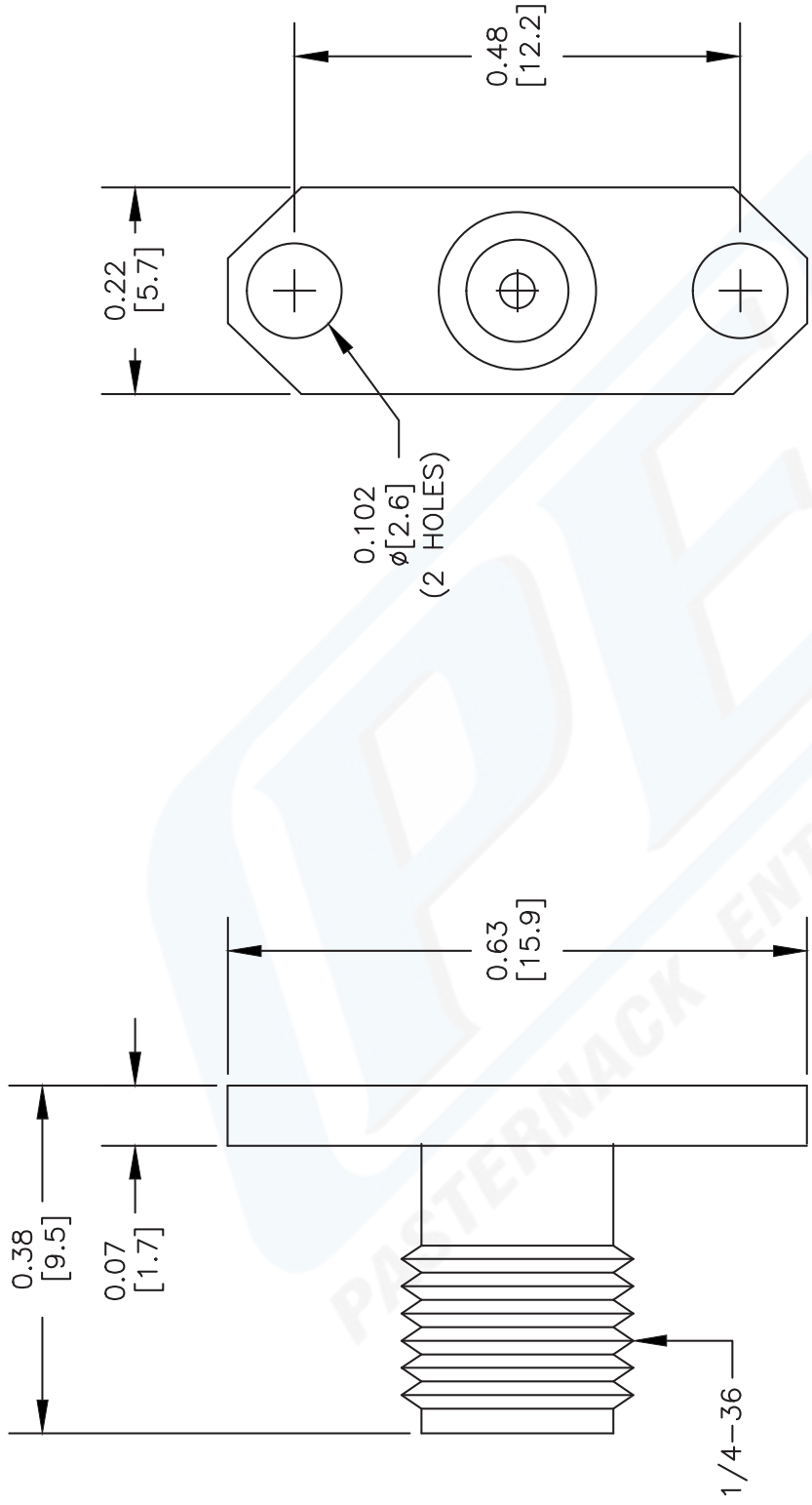

NOTES:
1. UNLESS OTHERWISE SPECIFIED ALL DIMENSIONS ARE NOMINAL.
2. ALL SPECIFICATIONS ARE SUBJECT TO CHANGE WITHOUT NOTICE AT ANY TIME.
3. DIMENSIONS ARE IN INCHES [mm].
4. FITS MIL-C-17 AND EQUIVALENT CABLES.

DWG TITLE
PE44026

FSCM NO. 53919

CAD FILE 061902
SCALE N/A
SIZE A
2233

PE PASTERNAK®
Pasternack Enterprises, Inc.
P.O. Box 16759 | Irvine | CA | 92623
Phone: (949) 261-1920 | Fax: (949) 261-7451
Website: www.pasternack.com | E-Mail: sales@pasternack.com